



www.a1batterypro.com.au



# DC7-12

## CYCLING CAPACITY

20 Hour Rate     **7 Amp Hours**

## RESERVE CAPACITY

Reserve @25 AMPS     -     Reserve @75 AMPS     -

## ELECTRICAL SPECIFICATIONS

Nominal Voltage	<b>12 Volt</b>
C100	<b>7.5 AH</b>
C20	<b>7 AH</b>
C10	<b>6.3 AH</b>
C5	<b>5.7 AH</b>
C3	<b>4.8 AH</b>
C2	<b>4.2 AH</b>
C1	<b>4 AH</b>
Internal Resistance	<b>19m Ω</b>

## MECHANICAL SPECIFICATIONS

Group Size	-	
Terminal Type	<b>F1</b>	
Terminal Torque	<b>See reverse side</b>	
Height (w/ terminal)	<b>3.98"</b>	<b>101mm</b>
Height (case only)	<b>3.74"</b>	<b>95mm</b>
Width	<b>2.56"</b>	<b>65mm</b>
Length	<b>5.94"</b>	<b>151mm</b>
Weight	<b>5.94 lbs.</b>	<b>2.7 kg</b>
Case Type	<b>ABS Plastic - Flame Res. Rating UL94-HB</b>	

## DISCHARGE TABLE (Constant Current)

Time	Amps	Rate
20hr	0.35	0.05CA
10hr	0.63	0.10CA
8hr	0.8	0.13CA
5hr	1.1	0.20CA
3hr	1.6	0.33CA
2hr	2.1	0.50CA
1hr	4	1.00CA

## DISCHARGE PROFILE (Constant Current)

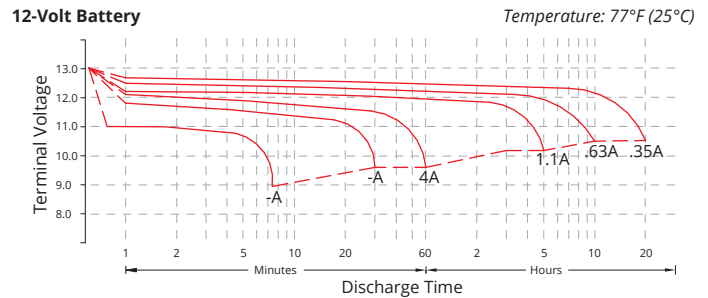

- All listed ratings are @ 100% SoC, T=77°F (25°C), 1.75VPC unless otherwise specified.  
 - Specifications listed are for estimation purposes only. Battery performance can vary depending on application. Battery design subject to change.

## BATTERY & TERMINAL DIMENSIONS (All units shown in mm)

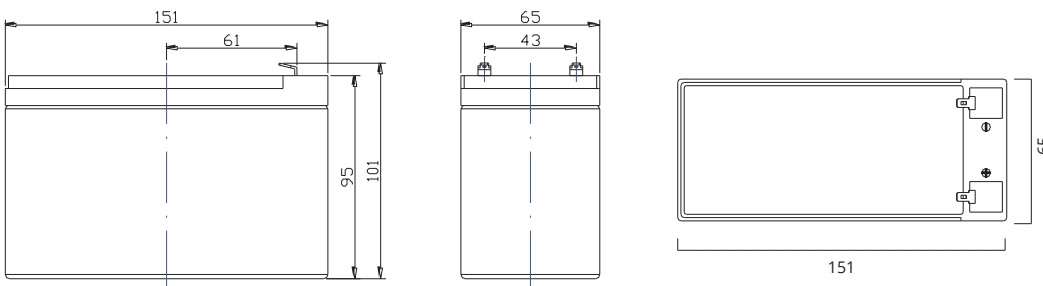

### Terminal: F1

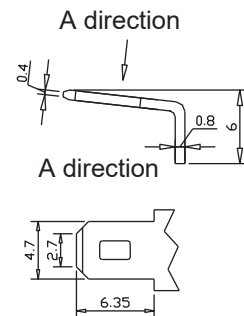

## Two Great Stores to choose from...

7 Cemetery Rd,  
Mackay QLD 4740  
Phone 07 4957 6123

Unit 16, 547 Woolcock St,  
Mt Louisa, Townsville QLD 4814  
Phone 07 4774 7344

PREMIUM DEEP CYCLE SERIES | DEEP CYCLE AGM

### TEMPERATURE vs CAPACITY

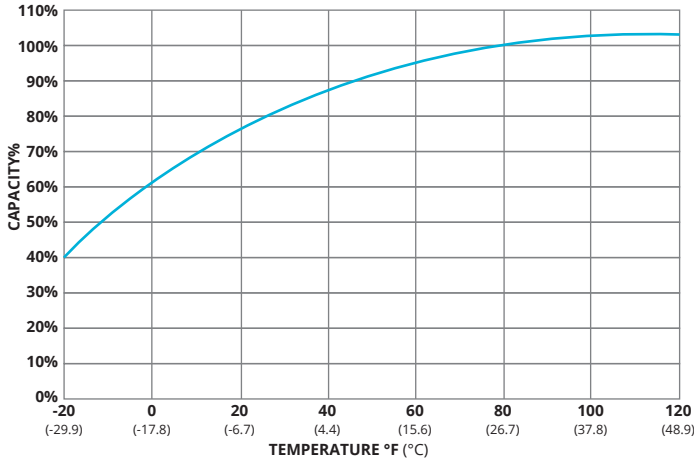

### STATE of CHARGE (SOC) vs OPEN CIRCUIT VOLTAGE (OCV)

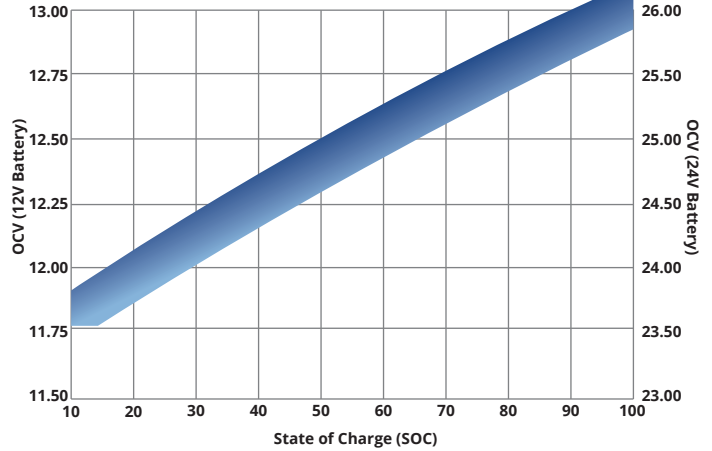

### CYCLE LIFE vs DEPTH of DISCHARGE (DOD) \*(Based on BCI Testing @ 2-hr Rate)

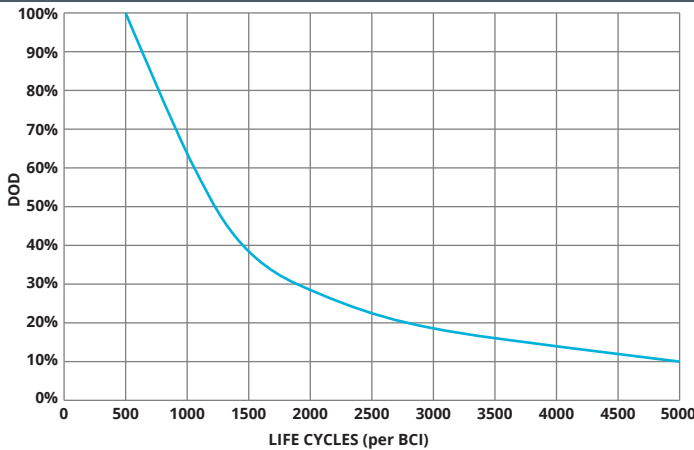

### SELF DISCHARGE vs TIME/TEMPERATURE

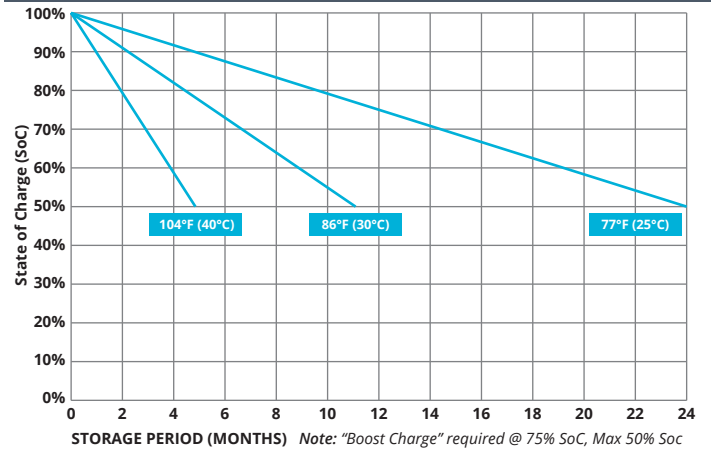

### TEMPERATURE RANGE SPECIFICATIONS

Condition	Recommended	Maximum	Recommended	Maximum
Storage	5°F to 122°F	-40°F to 160°F	-15°C to 50°C	-40°C to 71°C
Operation	5°F to 104°F	-40°F to 160°F	-15°C to 40°C	-40°C to 71°C
Charge with TC	5°F to 122°F	-40°F to 160°F	-15°C to 50°C	-40°C to 71°C
Charge w/o TC	32°F to 104°F	5°F to 122°F	0°C to 40°C	-15°C to 50°C

\*TC= Temperature Compensation

### CHARGE VOLTAGES

Charge Stage	Battery Voltages			
	12V	24V	36V	48V
Bulk	14.7V	29.4V	44.1V	58.8V
Absorption	14.7V	29.4V	44.1V	58.8V
Float	13.6V	27.2V	40.8V	54.6V

TC Factor: (-2mV/°F/cell) or (-4mV/°C/cell)

### TERMINAL TORQUE SPECS (applicable values are highlighted)

M6	M8	M10	M6M (Stud)	M8M (Stud)	M10M (Stud) & 3/8" Stud	FR45	TP06 (AP)	TP08/TP68 (AP)	AP
3.3-4.8ft-lbs	5.2-6.7ft-lbs	8.1-10.3ft-lbs	2.6-3.7ft-lbs	4.4-5.9ft-lbs	7.4-8.8ft-lbs	4.8-6.3ft-lbs	2.6-3.3ft-lbs	4.6-6.3ft-lbs	4.2-5.8ft-lbs
40-57.5lbs-in	62-80lbs-in	97-124lbs-in	31-44lbs-in	53-71lbs-in	88.5-106lbs-in	57-75lbs-in	31-40lbs-in	55-75lbs-in	50-70lbs-in
4.5-6.5Nm	7-9Nm	11-14Nm	3.5-5Nm	6-8Nm	10-12Nm	6.5-8.5Nm	3.5-4.5Nm	6.2-8.5Nm	5.6-7.9Nm

### Two Great Stores to choose from...

7 Cemetery Rd,  
Mackay QLD 4740

Phone 07 4957 6123

Unit 16, 547 Woolcock St,  
Mt Louisa, Townsville QLD 4814

Phone 07 4774 7344