

# MOTOBATT

QuadFlex™ Battery  
 WWW.MOTOBATT.COM  
 MB12U

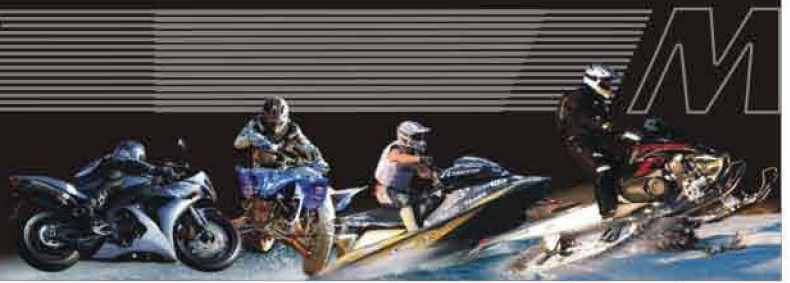

## Features

- Patented Quad Terminal Design - Reduce carrying costs
- 12V VRLA Hi Capacity Starting Battery
- Absorbed Glass Mat (AGM) technology
- Brass Terminals - superior conductivity
- US IATA certified non-spillable
- Highest AH Capacity in the Industry
- Factory Activated-Ready to Install

## Performance Specifications

**Nominal Voltage** ----- 12 volts (6 cells)

### Nominal Capacity

20-hr. (0.75A to 10.50 volts)	-----	15.5 AH
10-hr. (1.5A to 10.50 volts)	-----	15.0AH
5-hr. (3.0A to 10.20 volts)	-----	12.8AH
1C. (15.0A to 9.6 volts)	-----	43Min (10.7AH)
8C. (120A to 6.00 volts)	-----	3Min (6.0AH)

**Approximate Weight** ----- 9.70 lbs. ( 4.40kg)

**Energy Density (20-hr. rate)** ----- 1.75W-h/in<sup>3</sup> (106.6 W-h/l)

**Specific Energy (20-hr. rate)** ----- 19.1W-h/lb (42.1W-h/kg)

**Internal Resistance (approx)** ----- 18 milliohms

**CCA (-0.4°F/-18°C,7.2V,30S)**----- 160 amperes

**CA (68°F/20°C,7.2V,30S)**----- 270 amperes

**Shelf Life** (% of nomomal capacityat 68°F (20°C)---- SOC% OCV

1 Months	-----	97%	12.78V
3 Months	-----	91%	12.7V
6 Months	-----	83%	12.5V

### Operating Temperature Range

Charge ----- -4°F(-20°C) to 122°F(50°C)  
 Discharge ----- -40°F (-40°C) to 140°F(60°C)

**Case** ----- ABS

**Carton Contents** -----1-MotoBatt MB12U Battery,  
 Fit spacers (1 bottom),4 stainless steel terminal screws, 2 brass terminals, 4mm Allen Wrench, Install / user manual.



RETAIL CARTON



\*CY TERMINAL TERMINAL COVER SCREW WRENCH

## Brass Terminals (mm)

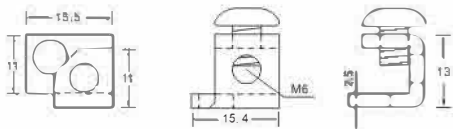

Terminal Screws: Stainless, M6 Thread  
 Fastener: 4mm Allen Hex

## Physical Dimensions: (in./mm)

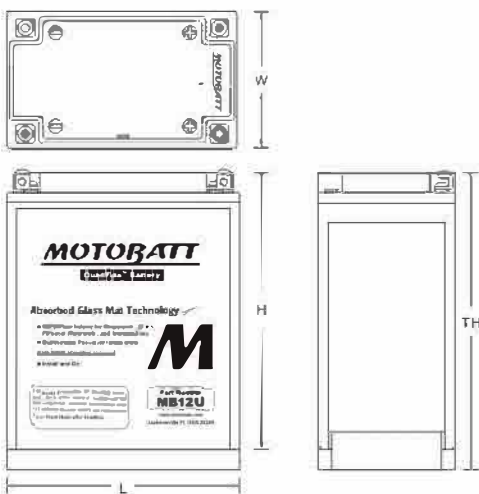

L:5.31(135) W:3.15(80) H:6.34(161)  
 TH:.6.89(175)

Tolerances are +/-0.04in.(+/-1mm) and +/-0.08in.(+/-2mm) for height dimensions.

### Shelf life & Storage

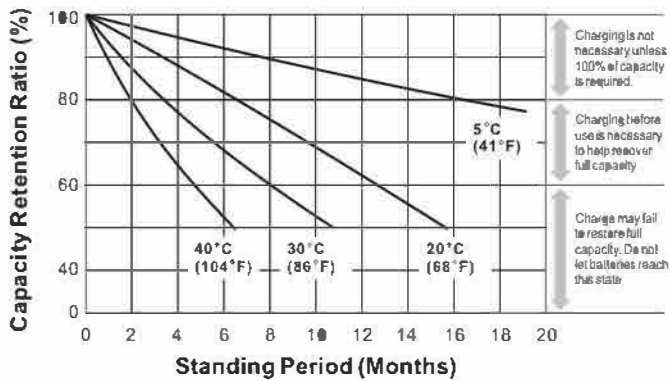

### Discharge Characteristics

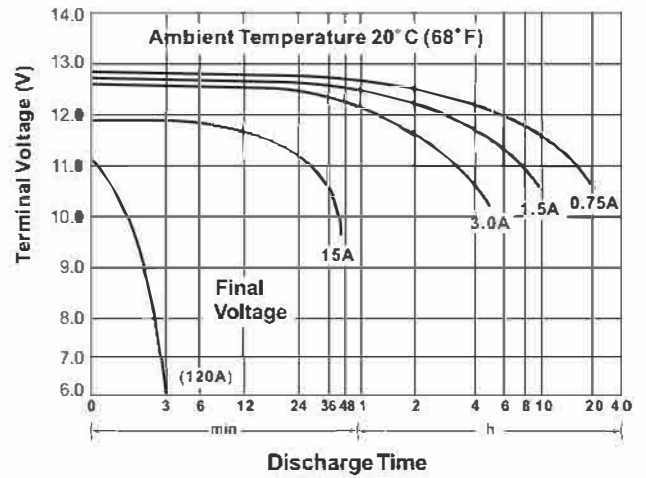

### Discharge Time vs. Discharge Current

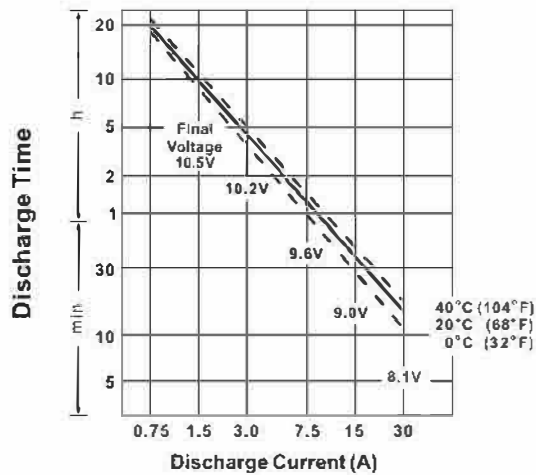

### Life Characteristics in Cyclic Use

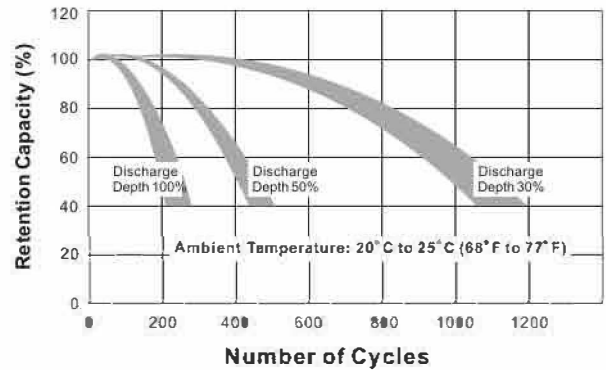

### Charging

**Cycle Applications:** limit initial current to 4.5A. Charge until battery voltage (under charge) reaches 14.8 to 15.0 volts at 68°F (20°C). Hold at 14.8 to 15.0 volts until current drops to under 300mA. Battery is fully charged under these conditions, and charger should be disconnected or switched to "float" voltage.

**Note:** Due to the self-discharge characteristics of this type of battery, it is imperative that they be charged within 6 months of storage, otherwise permanent loss of capacity might occur as a result of sulfation.

### Chargers

MotoBatt offers a wide range of chargers suitable for batteries up to 4A. Please refer to the charger selection guide. Please contact our technical department for advice if you have difficulty in locating suitable models or contact us at [www.motobatt.com](http://www.motobatt.com).

### Can be used to replace

YB12AA	YB12AAS	YB12AAWS	YB12ALA
YB12ALA2	YB12AB	YB12CA	12N124A
12N12A4A1			

### Further Information

Please refer to our website [www.motobatt.com](http://www.motobatt.com) to locate a distributor in your area.